

2385 MARYLAND ROAD WILLOW GROVE, PA 19090

INDUSTRIAL
INVESTMENTS

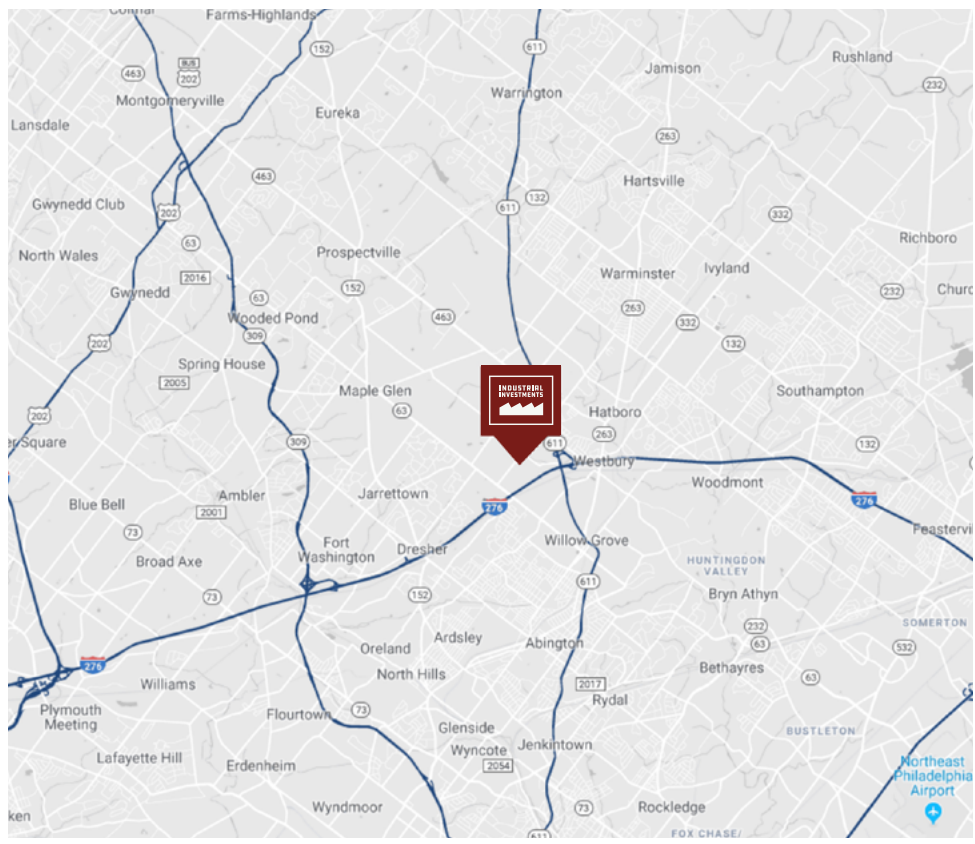

- 32,950 sq. ft. on 3.7 Acres
- 1/4 Mile to PA Turnpike Exit
- Rental Units from 3,830 sq. ft.
- Outside Storage Available



FOR MORE INFORMATION: | 215.542.8017 | INDUSTRIALINVESTMENTS.COM

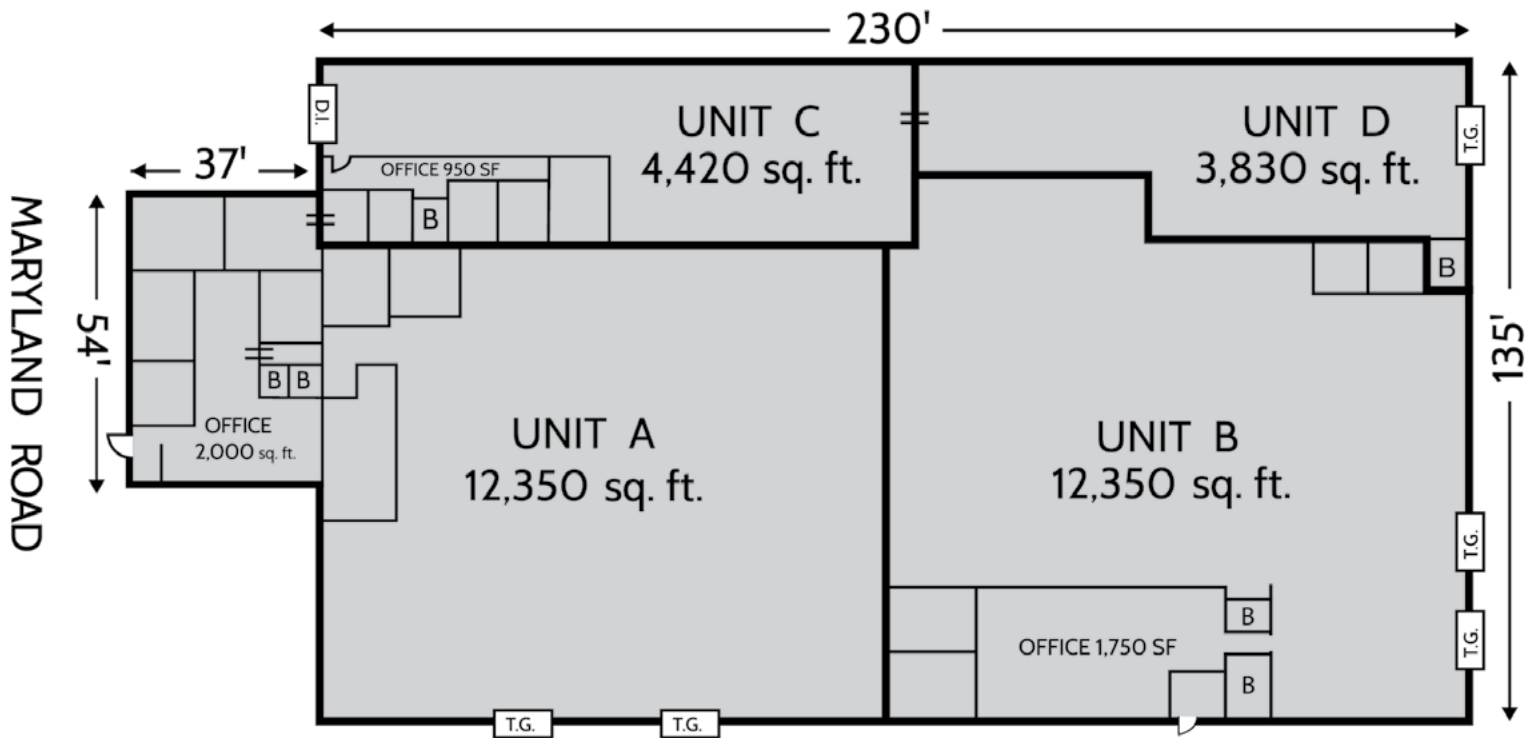

FEATURES

- 16' Clear Ceilings
- Tailgate & Drive In Loading
- 3-Phase Heavy Power
- Gas-Fired Suspended Heaters
- Masonry & Steel Construction
- Fluorescent Lighting
- Public Water and Sewer
- Zoned Limited Industrial